

# PLANT PALETTE

## FULL SUN GARDENS 2 & 3

### PLANTING DETAILS

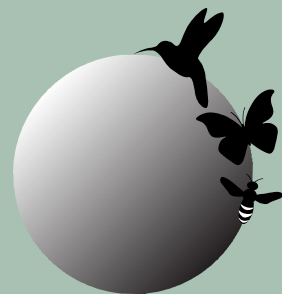
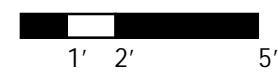
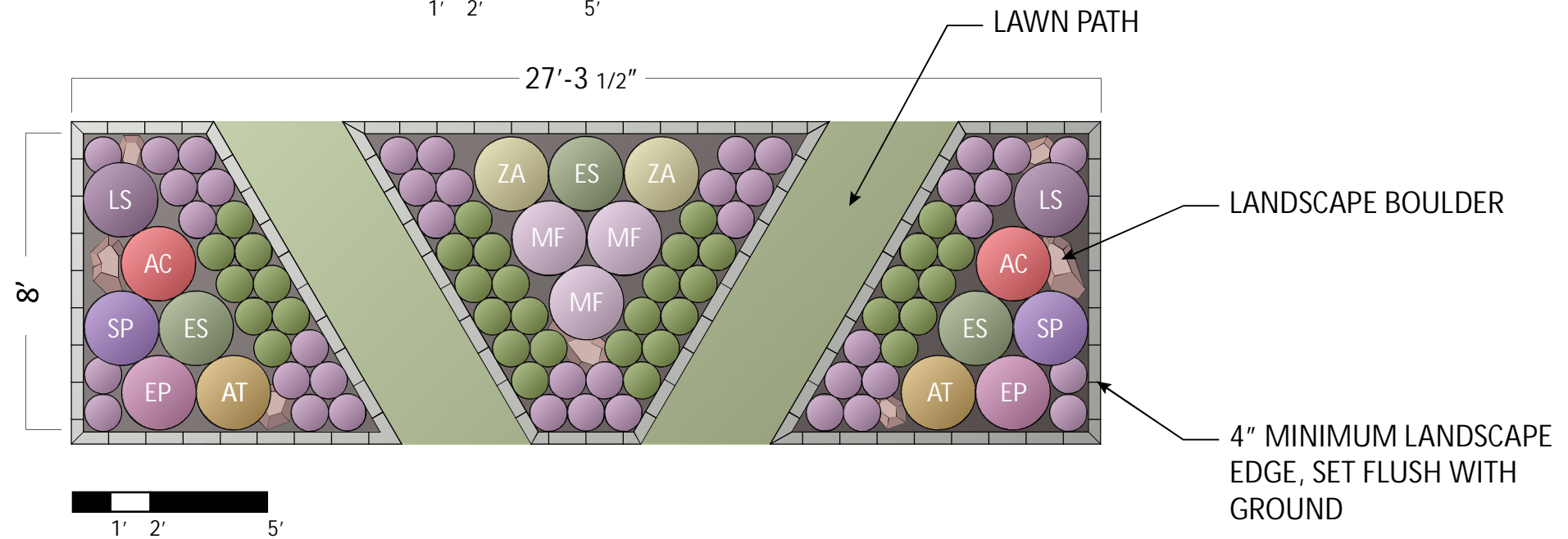
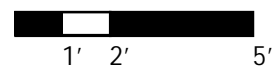
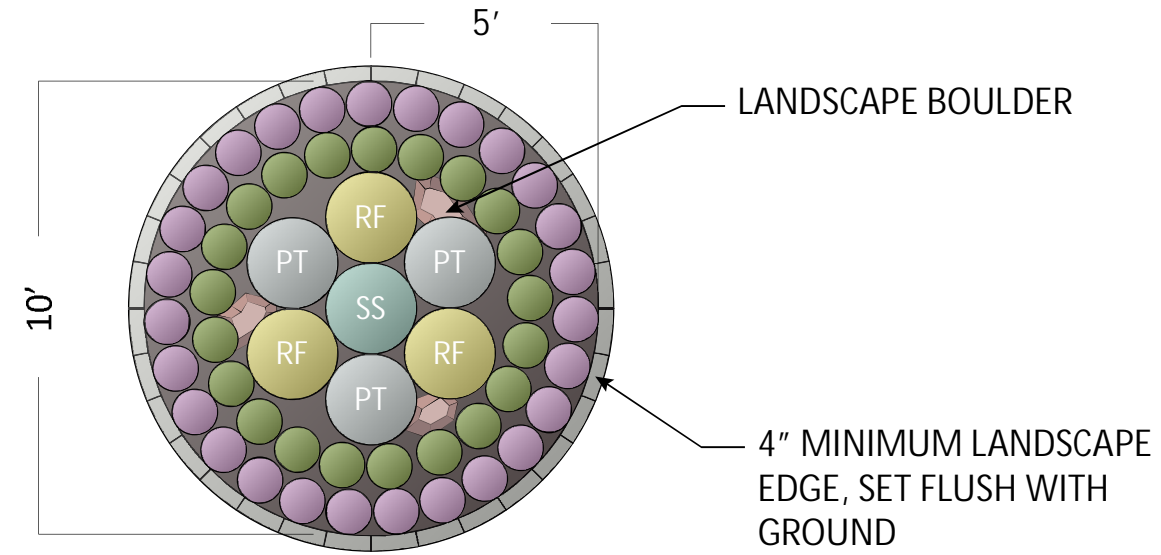
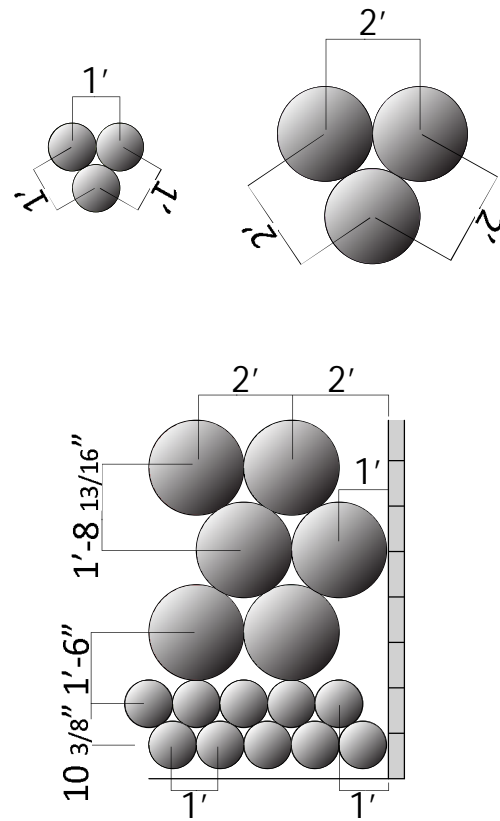

Note:  
Hummingbirds, butterflies,  
and bees are all frequent  
visitors of the forbs listed.



Carex blanda  
Common wood sedge



ES  
Eragrostis spectabilis  
Purple lovegrass



SS  
Schizachyrium scoparium  
Little bluestem

HT: 1'

HT: 1-2'

HT: 2-4'

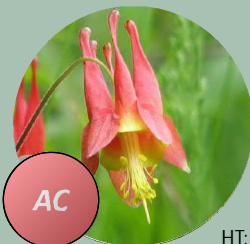

AC  
Aquilegia canadensis  
Red columbine



AT  
Asclepias Spp.  
Milkweed species



EP  
Echinacea purpurea  
Purple coneflower



HT: 0.5-1.5'

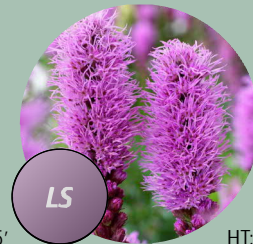

LS  
Liatris spicata  
Dense blazingstar



MF  
Monarda fistulosa  
Wild bergamot



PT  
Pycnanthemum tenuifolium  
Narrowleaf mountainmint



RF  
Rudbeckia fulgida  
Orange coneflower



SP  
Symphyotrichum patens  
Late purple aster



ZA  
Zizia aurea  
Golden zizia

HT: 2-3'

HT: 1-2.5'

HT: 2-5'

HT: 0.5-1.5'

HT: 2-4'

HT: 2-4'

HT: 2-3'

HT: 2-3'

HT: 2-3'

HT: 1.5-3'